

Suitable for interior or exterior applications. A lightweight, vapor tight, nonmetallic fixture ideal for corrosive or wet/damp environments. The 376 fixture features a fiberglass housing with an acrylic or polycarbonate lens, a continuous gasket design, along with an optional aluminum reflector available upon request. The 376 is ideal for commercial industrial or institutional applications providing maximum light output where humidity, dust, or fumes are possible. The 376 is resilient against corrosion and weathering. Lamps not included.

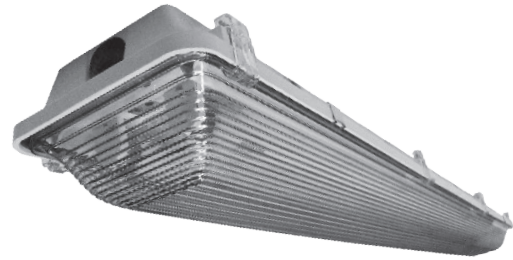

Additional Applications:

Machining Areas • Prep Areas • Tunnels • Wash Down Areas

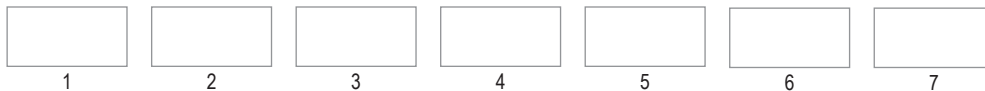

1 SERIES	2 LAMP TYPE	3 LAMP QUANTITY	4 LENGTH	5 VOLTAGE
376	T5: 14W, 28W* T5HO: 24W, 54W T8: 17W, 32W, 59W* T8HO: 86W* (8' fixture only)	1L: 1 Lamp (4' only) 2L: 2 Lamp 3L: 3 Lamp (T5 and T8 only) 4L: 4 Lamp (8' only) 6L: 6 Lamp (8' T5 and T8 only)	2: 2 Ft. 4: 4 Ft. 8: 8 Ft.	UNV: 120-277V 50/60Hz 120: 120V 50/60Hz 277: 277V 50/60Hz 347: 347V 50/60Hz
6 LENS			7 OPTIONS	
PR: Polycarbonate Ribbed Lens (2' and 4' only) A: Acrylic Ribbed Lens (4' 2 or 3 Lamp and 8' only) AC: Acrylic Optically Clear Lens (4' 2 or 3 lamp and 8' only) FA: Frosted Acrylic Lens (4' 2 or 3 lamp and 8' only) (Not NSF listed)			SL: Stainless Steel Latches HB: Enhanced Alum. Refl. 0.30" => 93% reflective EM: Battery/Driver Backup (90 Min.) WD: Wide distribution enhanced aluminum reflector (Used with AC lens ONLY) (4' 2 lamp fixture, 8' fixture with (2) 8' lamps or 8' fixture with (4) 4' lamps only)	

Notes:

* IP 65 for MAX (2) 32 W lamps 4 Ft. housing and (4) 32 W lamps 8 Ft. Housing.
IP 55 for all models 2 Ft., 4 Ft., and 8 Ft
LDPI, Inc. stocks multiple configurations. Consult factory.
For chemical resistance information please see website.

Optional Mounting Ordered Separately	
45° Mounting bracket kit (SS) (8' fixture requires 2 kits)	Chain hung Mounting bracket bail kit (8' fixture requires 2 kits)
P/N 5151: 1 lamp housing	P/N 5192: Narrow housing
P/N 5102SS: 2 or 3 lamp housing	P/N 5193: Standard housing

LISTINGS

UL 1598A Marine Inside
UL 1598 Wet / Damp
CSA 22.2 No. 250.0
NSF: Splash Zone Non-Food Prep
NEMA 4X
IP65 - 2ft, IP55 ALL
25°C Ambient Rating

FEATURES

Fiberglass: 5VA UL rated
Available lengths: 2', 4' and 8'

GASKETING

Poured in place polyurethane gasket and cam latches seal the enclosure from the most hostile environments.
Provides continuous positive gasket contact.

MOUNTING

Economical system can provide dramatic savings on the installation labor. Durable stainless steel Mounting hardware.
No drilling necessary for the housing for installation.

FINISH

Housing: White polished fiberglass. Gear tray: white enamel

DIFFUSER

PR: UV stabilized polycarbonate lens with lineal ribs.
A: UV stabilized impact resistant acrylic lens with lineal ribs.
(Meets UV requirements of UL 756C)
AC: Acrylic optically clear lens (4' 2 or 3 lamp and 8' only)
FA: Frosted acrylic lens (4' 2 or 3 lamp and 8' only) (Not NSF listed)

ELECTRICAL

Available in 14, 17, 24, 28, 32, 54, 59 and 86 watts with T5, T5HO, T8, and T8HO lamps
Voltages of 120, 277 and 347
All electric components are UL and CSA approved.
Full metal gear tray carries all electrical components and provides for a positive ground.

OPTIONS

SL: Stainless steel latches
HB: 93% reflective specular reflector
EM: Battery/Driver Backup (90 Min.)
Not available in 2' fixture 120 or 277V. MUST SPECIFY
WD: Wide distribution enhanced aluminum reflector - (Requires AC or FA lens)

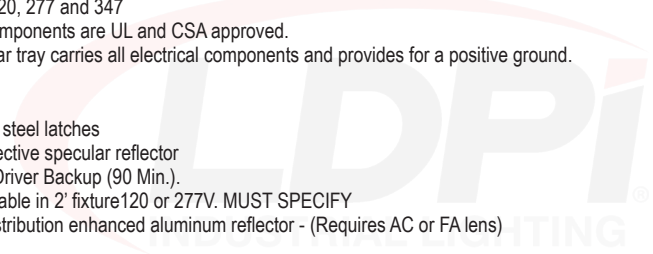

376

WET / DAMP LIGHTING

Food & Beverage Processing • Industrial • Pulp & Paper • Shipyards / Marine • Water Treatment

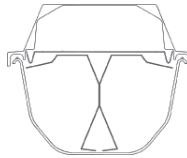

2 lamp fixture with wide distribution (WD) lens and the acrylic optically clear (AC) lens
NOTE: AC lens is 3.5" deep.

DIMENSIONS

Narrow 1 lamp

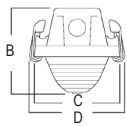

Diffuser/Lens depth: 2.13"
AC and FA lens depth: 3.5"

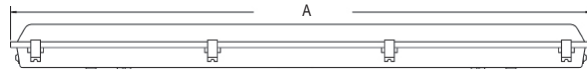

Standard 2+ lamps

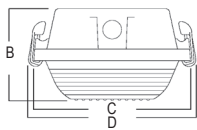

AC and FA acrylic lens

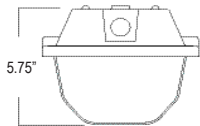

PART #	A	B	C	D
376-__1L-4-UNV-__	51.75"	4.25"	4.00"	4.56"
376-__1L-5-UNV-__	63.50"	4.25"	4.00"	4.56"
376-__2L-2-UNV-__	27.25"	4.25"	6.75"	7.33"
376-__3L-2-UNV-__	27.25"	4.25"	6.75"	7.33"
376-__2L-4-UNV-__	51.75"	4.25"	6.75"	7.33"
376-__3L-4-UNV-__	51.75"	4.25"	6.75"	7.33"
376-__2L-8-UNV-__	100"	4.25"	6.75"	7.33"
376-__4L-8-UNV-__	100"	4.25"	6.75"	7.33"
376-__6L-8-UNV-__	100"	4.25"	6.75"	7.33"

"B" measurement: with Poly Molded diffuser. Poly Ribbed diffuser will measure 0.12" shorter.
"B" measurement with Acrylic Optically Clear lens is 5.75".

376 Shipping Dimensions

Product	Weight	Volume	L W H
376-1L-4	8#	1.09 Cu.. Ft.	59" L 8" W 4" H
376-1L-5	10#	1.29 Cu.. Ft.	70" L 8" W 4" H
376-2L-2	6#	.66 Cu.. Ft.	36" L 8" W 4" H
376-2L-4	12#	1.09 Cu.. Ft.	59" L 8" W 4" H
376-2L-8	20#	2.47 Cu.. Ft.	107" L 8" W 5" H
376-3L-2	6#	.66 Cu.. Ft.	36" L 8" W 4" H
376-3L-4	12#	1.09 Cu.. Ft.	59" L 8" W 4" H
376-4L-8	21#	2.47 Cu.. Ft.	107" L 8" W 5" H
376-6L-8	23#	2.47 Cu.. Ft.	107" L 8" W 5" H

MOUNTING

- Mounting brackets provide impressive benefits.
- Offers a huge advantage over more traditional enclosures.
- Durable, stainless steel Mounting hardware.
- No drilling necessary for the housing for installation.
- Installation time is dramatically reduced, providing lower installation costs.

STANDARD Mounting BRACKET Kits

Included with each fixture

P/N 6685: 1 lamp housing

P/N 6686: 2 or 3 lamp housing

Two brackets per kit. 1 kit needed per fixture.

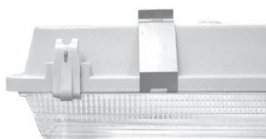

Mounting bracket for narrow and standard lamp housing.

OPTIONAL Mounting

45° Mounting bracket kit (8' fixture requires 2 kits)

P/N 5151: 1 lamp housing

Kit includes:

- (2) 45° brackets and
- (2) 5080 brackets

P/N 5102SS: 2 or 3 lamp housing

Kit includes:

- (2) 45° brackets (304 Stainless Steel)
- (2) 5081 brackets (304 Stainless Steel)

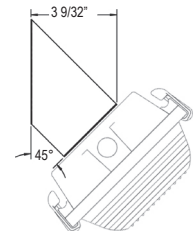

45° Mounting option

Chain hung Mounting bracket bail kit (8' fixture requires 2 kits)

P/N 5192: Narrow housing

P/N 5193: Standard housing

Kit includes:

- (2) S-hooks
- (2) 2' lengths of chain
- (2) 5150 chain hang looms
- (2) 5080 brackets (narrow housing only)
- (2) 5081 brackets (standard housing only)

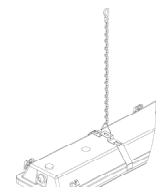

Chain hung Mounting option